

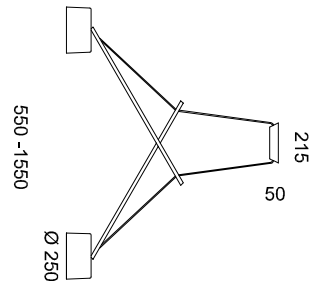
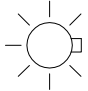
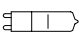

TWIN

mm	 <p>215 50 550 - 1550 Ø 250 min. 1100 - max. 2000</p>		
kg	3,4		
	 <p>2 x 60W G9</p>		
			

serien
.lighting

serien Raumleuchten GmbH Hainhäuserstr. 3-7 D-63110 Rodgau
www.serien.com

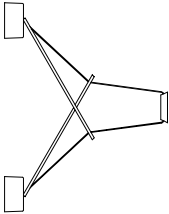

Design Hans Karuga

- D** Vor Montage der Leuchte Sicherung ausschalten!
- GB** Before assembling the luminaire, turn off power at the mains!
- F** Veuillez couper le courant avant de monter le luminaire!
- I** Prima del montaggio della lampada staccare il fusibile!
- E** Desconecte el fusible antes de montar la lampara!
- NL** Schakel voor de montage van de lamp de zekering uit!

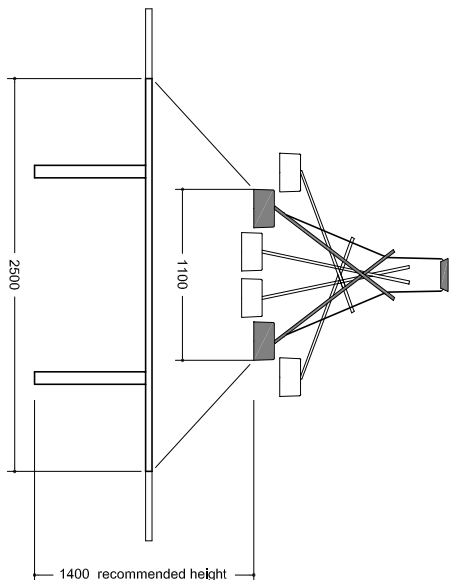

01

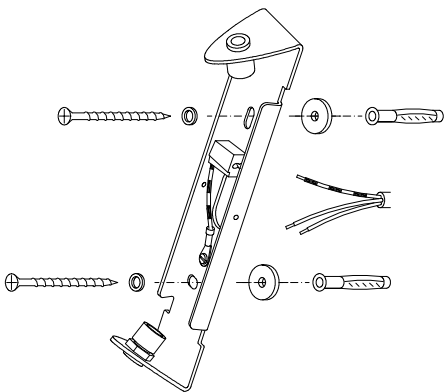

02

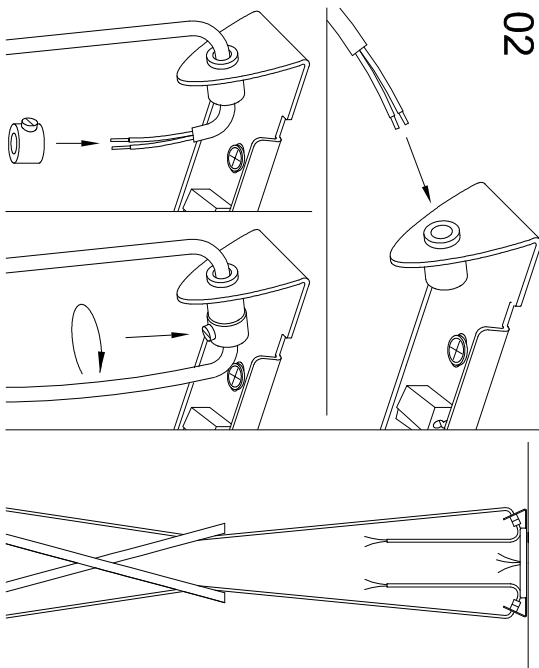

03

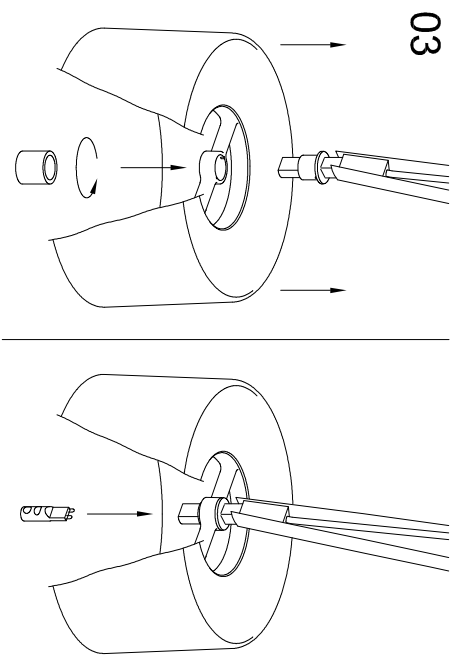

04

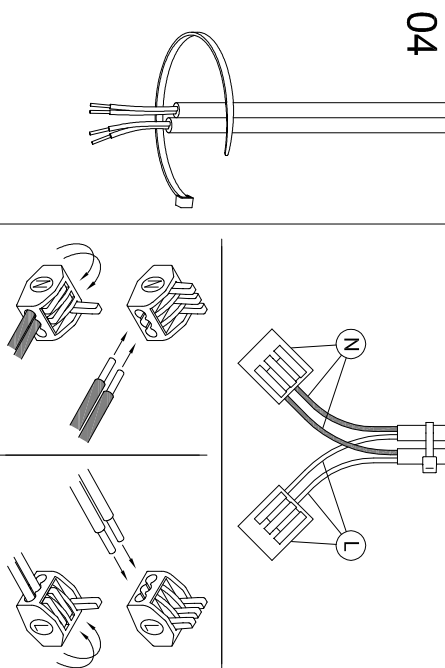

05

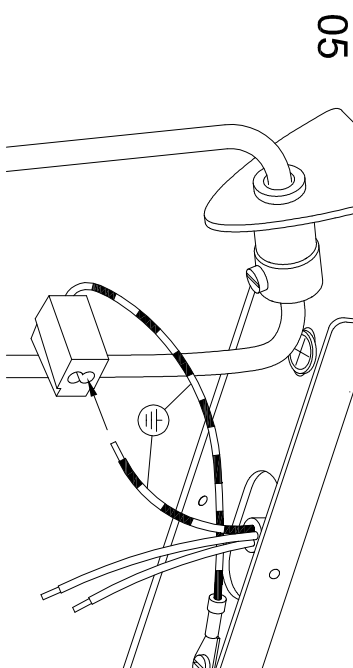

06

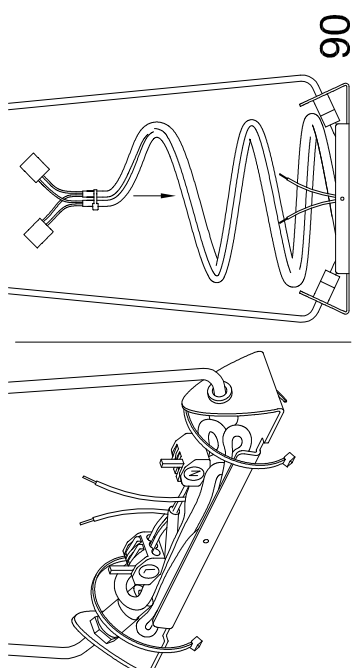

07

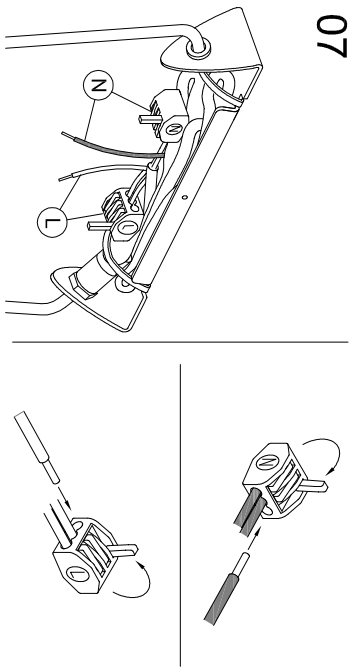

08

